

A08031.60

**Single Bundle, A08031.60**

Single Bundles

For versatility in routing and positioning of light, flexible bundles are your answer.

Features

- Tight bending radius for easy routing.
- A variety of standard sizes. See chart below for part numbers and specifications. Dual and quad bundles are found on a separate page in the product catalog. (05.02.01)
- The standard output ferrules accept spot lenses accept polarizing caps. (See the Accessories section of the product catalog for more details.)
- Standard input accepts Dichroic color filters, diffusers and ColdVision Series light sources.
- Support products are available in the Support Apparatus section of the product catalog. Adaptors may be required.
- Custom configurations are available. Lead time is required.

| Bundles | | | | |
|-----------|-----------------------------|-------------------------|-----------------|---------------|
| Part No. | Active Input Fiber Diameter | Distal Ferrule Diameter | Tubing Diameter | Bundle Length |
| A08020.40 | .20" (5) | .393" (10) | .39" (10) | 40" (1016) |
| A08020.60 | .20" (5) | .393" (10) | .39" (10) | 60" (1524) |
| A08025.40 | .25" (6) | .393" (10) | .47" (12) | 40" (1016) |
| A08025.60 | .25" (6) | .393" (10) | .47" (12) | 60" (1524) |
| A08031.40 | .30" (8) | .393" (10) | .47" (12) | 40" (1016) |
| A08031.60 | .30" (8) | .393" (10) | .47" (12) | 60" (1524) |
| A08031.80 | .30" (8) | .393" (10) | .47" (12) | 80" (2032) |
| A08051.40 | .51" (13) | .625" (16) | .75" (19) | 40" (1016) |
| A08051.60 | .51" (13) | .625" (16) | .75" (19) | 60" (1524) |
| A21200 | .40" (10) | .507" (13) | .69" (18) | 30" (762) |

Dimensions in () are in mm

Single Bundles

Dimensions in () are in mm

Ringlight Input: Black Anodized Aluminum

Bundle Sheathing: PVC Covered Metal Tubing

Product improvements may result in specification or feature changes without notice.

Warning: This product is manufactured with glass fiber. Not for use in cable/hose carrier. Call SCHOTT to discuss moving cable/hose carrier applications.

A08020.40 - A08051.60
Single Bundles

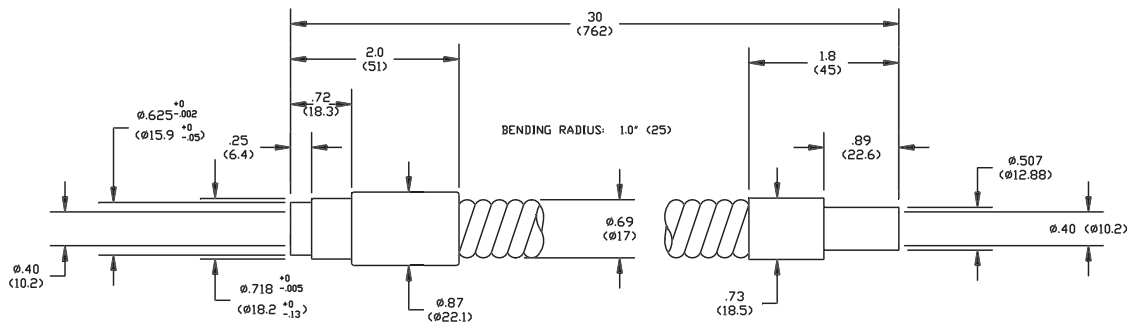
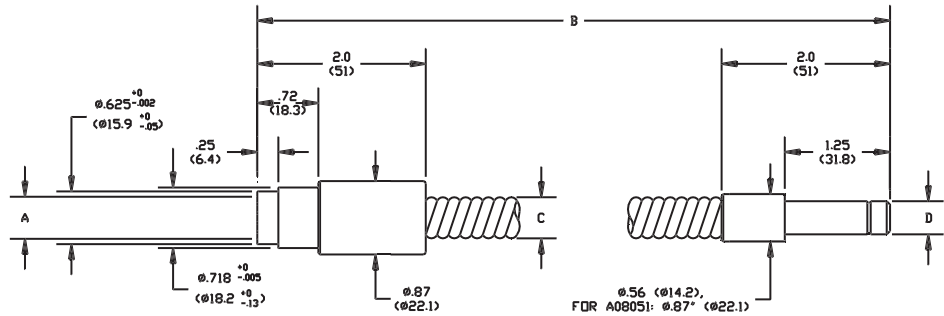

A21200
Bundle

Matrix for A08020.40 - A08051.60 Bundles

| Part No. | A | B | C | Bend Radius | D |
|------------------|-----------|------------|-----------|-------------|------------|
| A08020.40 | .20" (5) | 40" (1016) | .39" (10) | .5" (13) | .393" (10) |
| A08020.60 | .20" (5) | 60" (1524) | .39" (10) | .5" (13) | .393" (10) |
| A08025.40 | .25" (6) | 40" (1016) | .47" (12) | .6" (15) | .393" (10) |
| A08025.60 | .25" (6) | 60" (1524) | .47" (12) | .6" (15) | .393" (10) |
| A08031.40 | .30" (8) | 40" (1016) | .47" (12) | .6" (15) | .393" (10) |
| A08031.60 | .30" (8) | 60" (1524) | .47" (12) | .6" (15) | .393" (10) |
| A08031.80 | .30" (8) | 80" (2032) | .47" (12) | .6" (15) | .393" (10) |
| A08051.40 | .51" (13) | 40" (1016) | .75" (19) | 1.4" (36) | .625" (16) |
| A08051.60 | .51" (13) | 60" (1524) | .75" (19) | 1.4" (36) | .625" (16) |
| A21200 | .40" (10) | 30" (762) | .69" (18) | 1.0" (25) | .507" (13) |

Lighting and Imaging

SCHOTT North America, Inc.

122 Charlton Street

Southbridge, MA 01550

USA

Phone: +1508/765-9744

Fax: +1508/764-6273

E-mail: lightingimaging@us.schott.com

www.us.schott.com/lightingimaging

SCHOTT
glass made of ideas